



MU-30

46' 3G SINGLE EXPANDO W/ C-Band UPLINK OVERVIEW

Production

- Grass Valley K-Frame Switcher
- Kayenne 4-Stripe 35-Button Panel
- 5 M/Es, 64 input, 48 output
- FlexiKey, Double Take, and Chroma Key
- 16 iDPMs and 2D DPM
- ImageStore

Record & Playback

- (1) EVS XT3 6ch LSM Servers
- (1) EVS XT3 6ch RO/Spotbox w/ Lance Controller
- (1) EVS XFile 3
- Wired for (3) EVS*

Camera Equipment

- (8) Grass Valley LDX80 Worldcams
- (5) Grass Valley Super XPanders
- (8) LDK4426 Fiber Triax Converters
- (1) Canon 86x9.3 HD Lens
- (2) Canon 86x9.3 HD Lens
- (1) Canon 72x9.3 HD Lens
- (2) Canon 22x7.6 ENG Lens
- (1) Canon 11x4.7 Wide Angle Lenses
- **Wired for 10 CCUs***

Audio Facilities

- Calrec Artemis Digital Console - Bluefin 2
- 48 Fader / 240 DSP
- 96x120 Analog
- 32x32 AES
- 320x320 MADI
- 64x64 DANTE

Communications

- 166 x 166 RTS ADAM-M Digital Matrix Including
- 16 Rvon CHs, 64 OMNEO CH's
- 12 Powered Intercom Channels
- 12 Powered IFB Channels
- (11) Dual Listen BP325 Boxes
- (9) IFB 4030 Boxes
- (9) Single Muff Headsets
- (3) Double Muff Headsets
- (4) Telephone Interface
- (4) Innkeeper QKT Coupler

Terminal Equipment

- NVision NV8280 3G/HD Router (242x360) Includes:
- 80x80 Embedding/Dis-Embedding
- (20) Cobalt 3G UDC Frame Sync
- (10) For-A 9600 Frame Sync U/D/C w/CC
- Image Video TSI-3000
- 170x34 Multiview Capacity

A/V Support

- (5) HMD26 Annc Headsets
- (5) Studio Tech Annc Boxes
- (5) MD46 Stick Mics
- (6) MKH416 Shotgun Mics
- (6) MKH807 Long Shotgun Mics
- (4) MKH418 Stereo Shotgun Mics
- (4) 15" SDI Monitors
- (4) 21" SDI Monitors
- (2) LED Light Kits

Cable Inventory

- 7000' Triax Cable
- 2100' DT-12 Cable
- (1) 1000' TAC-12
- (1) 500' TAC-4
- (6) 100' 5x Coax Looms
- (1) 100' 10x Coax Looms

Power Requirements

- 1 Phase, 200 Amps, 208 Volts
- 2 Hot Legs, 1 Ground, (No neutral required)
- 150' feeder cable with camlock connectors

Truck Dimensions

- GVW – 80,000 Lbs
- Dimensions – 46' L, 21' W, 13.5' H working footprint
- 22ft H with dish deployed

Transmission Capabilities

- 2.4 AVL C-Band Uplink Antenna
- (2) Advantech 300-watt Hub Mount C-Band SSPB
- (2) Adtec EN-100 Encoders
- (2) Adtec RD-70 Receivers

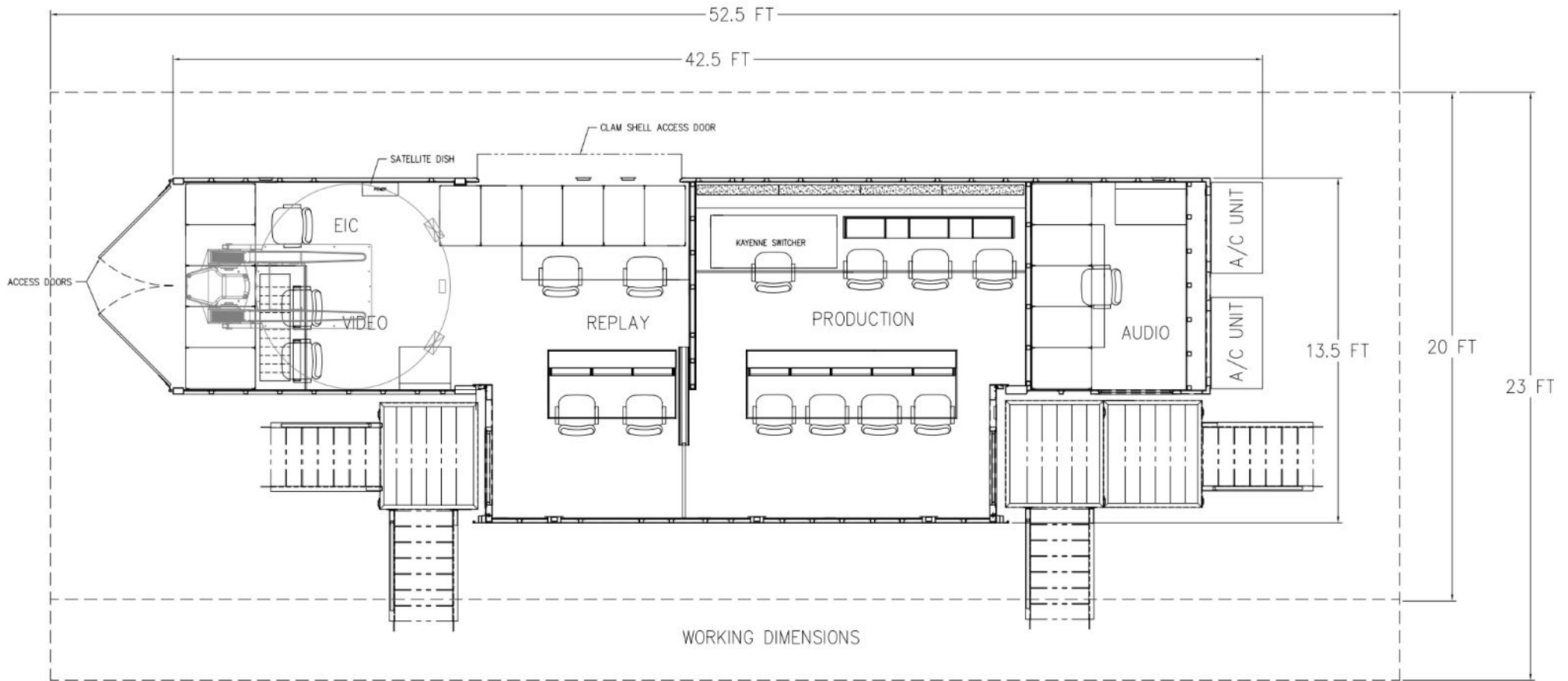

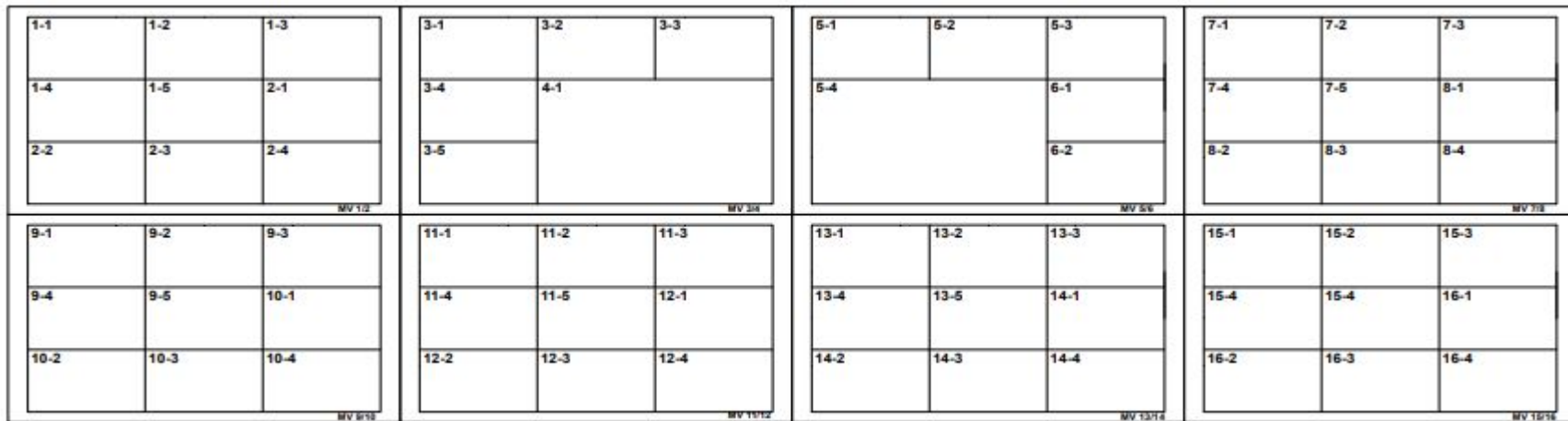

Technical Director

Director

Producer

AD-1



MU-30

46' SINGLE EXPANDO W/ C-Band UPLINK
SWITCHER INPUT / OUTPUT

CCU 01 -	FSY 01 -	FSY 13 -	EVS 1-1 -	AUX 01 -
CCU 02 -	FSY 02 -	FSY 14 -	EVS 1-2 -	AUX 02 -
CCU 03 -	FSY 03 -	FSY 15 -	EVS 2-1 -	AUX 03 -
CCU 04 -	FSY 04 -	FSY 16 -	EVS 2-2 -	AUX 04 -
CCU 05 -	FSY 05 -	FSY 17 -	CG A-1 -	AUX 05 -
CCU 06 -	FSY 06 -	FSY 18 -	CG A-2 -	AUX 06 -
CCU 07 -	FSY 07 -	FSY 19 -	CG B-1 -	AUX 07 -
CCU 08 -	FSY 08 -	FSY 20 -	CG B-1 -	AUX 08 -
	FSY 09 -	DECODE 1 -	Spot 1 -	ME 1 -
	FSY 10 -	DECODE 2 -	Spot 2 -	ME 2 -
	FSY 11 -		Spot 3 -	ME 3 -
	FSY 12 -		Spot 4 -	ME 4 -